

SOT-23 Plastic-Encapsulate Transistors (NPN)

FEATURES

- Complementary to S9015

MARKING: J6

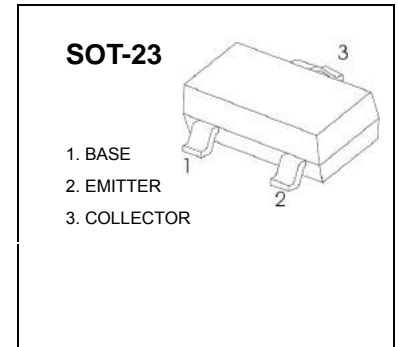

MAXIMUM RATINGS ($T_a=25^{\circ}\text{C}$ unless otherwise noted)

Symbol	Parameter	Value	Unit
V_{CBO}	Collector-Base Voltage	50	V
V_{CEO}	Collector-Emitter Voltage	45	V
V_{EBO}	Emitter-Base Voltage	5	V
I_{C}	Collector Current	100	mA
P_{C}	Collector Power Dissipation	200	mW
$R_{\theta\text{JA}}$	Thermal Resistance From Junction To Ambient	625	$^{\circ}\text{C}/\text{W}$
T_{j}	Junction Temperature	150	$^{\circ}\text{C}$
T_{stg}	Storage Temperature	-55~+150	$^{\circ}\text{C}$

ELECTRICAL CHARACTERISTICS ($T_a=25^{\circ}\text{C}$ unless otherwise specified)

Parameter	Symbol	Test conditions	Min	Typ	Max	Unit
Collector-base breakdown voltage	$V_{(\text{BR})\text{CBO}}$	$I_{\text{C}}=100\mu\text{A}$, $I_{\text{E}}=0$	50			V
Collector-emitter breakdown voltage	$V_{(\text{BR})\text{CEO}}$	$I_{\text{C}}=0.1\text{mA}$, $I_{\text{B}}=0$	45			V
Emitter-base breakdown voltage	$V_{(\text{BR})\text{EBO}}$	$I_{\text{E}}=100\mu\text{A}$, $I_{\text{C}}=0$	5			V
Collector cut-off current	I_{CBO}	$V_{\text{CB}}=50\text{V}$, $I_{\text{E}}=0$			0.1	μA
Collector cut-off current	I_{CEO}	$V_{\text{CE}}=35\text{V}$, $I_{\text{B}}=0$			0.1	μA
Emitter cut-off current	I_{EBO}	$V_{\text{EB}}=3\text{V}$, $I_{\text{C}}=0$			0.1	μA
DC current gain	h_{FE}	$V_{\text{CE}}=5\text{V}$, $I_{\text{C}}=1\text{mA}$	200		1000	
Collector-emitter saturation voltage	$V_{\text{CE}(\text{sat})}$	$I_{\text{C}}=100\text{mA}$, $I_{\text{B}}=5\text{mA}$			0.3	V
Base-emitter saturation voltage	$V_{\text{BE}(\text{sat})}$	$I_{\text{C}}=100\text{mA}$, $I_{\text{B}}=5\text{mA}$			1	V
Transition frequency	f_{T}	$V_{\text{CE}}=5\text{V}$, $I_{\text{C}}=10\text{mA}$ $f=30\text{MHz}$	150			MHz

CLASSIFICATION OF h_{FE}

Rank	L	H
Range	200-450	450-1000

SOT-23 Plastic-Encapsulate Transistors

Typical Characteristics

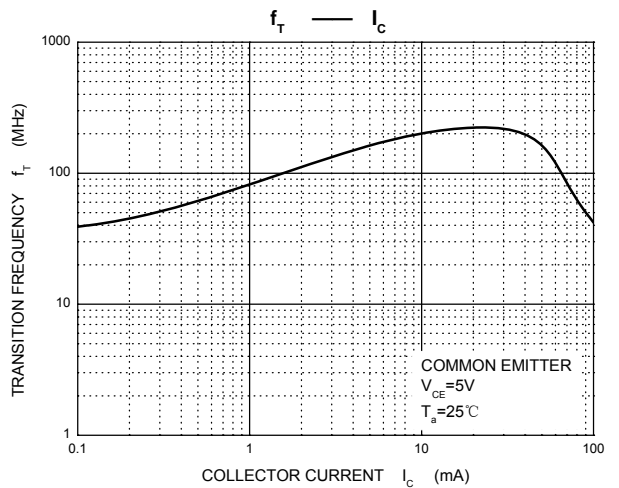
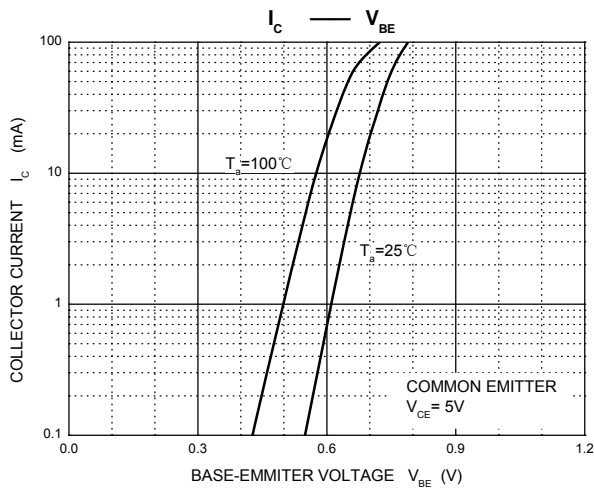
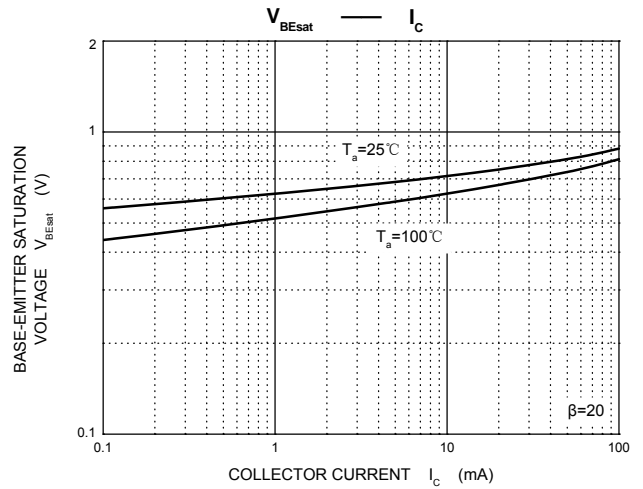
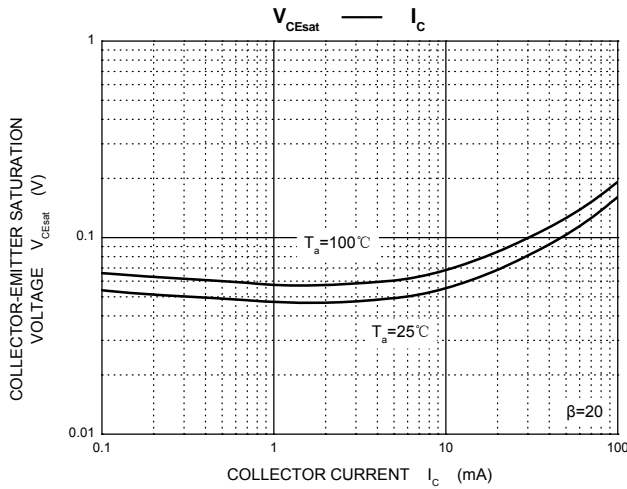
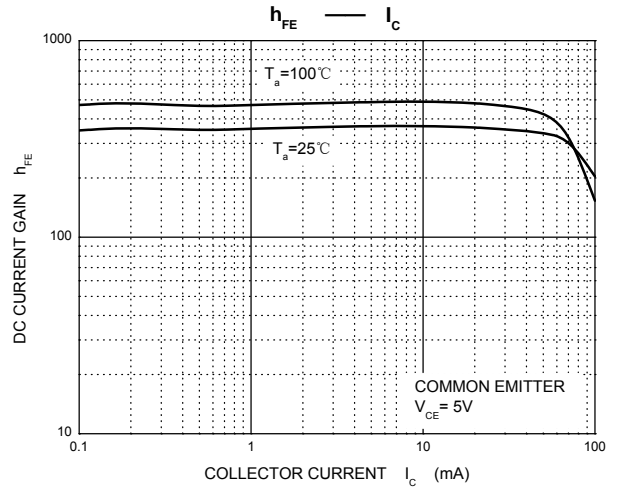
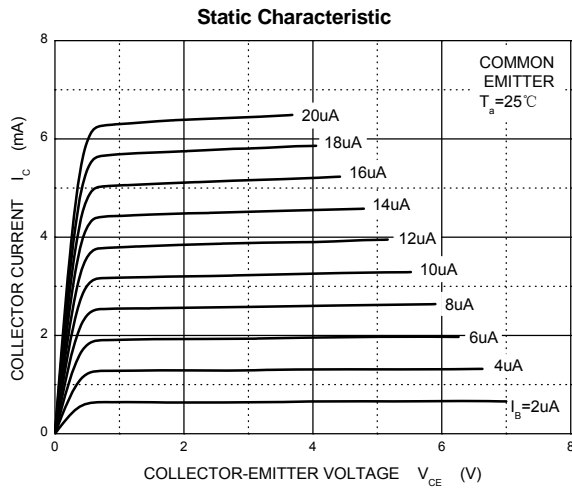

SOT-23 Plastic-Encapsulate Transistors

Typical Characteristics

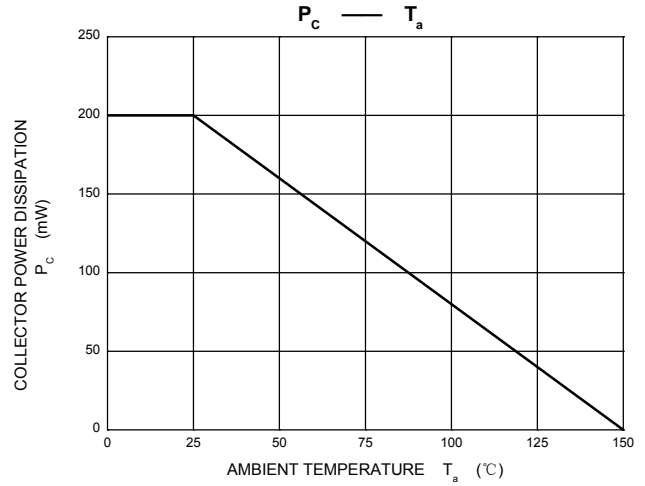
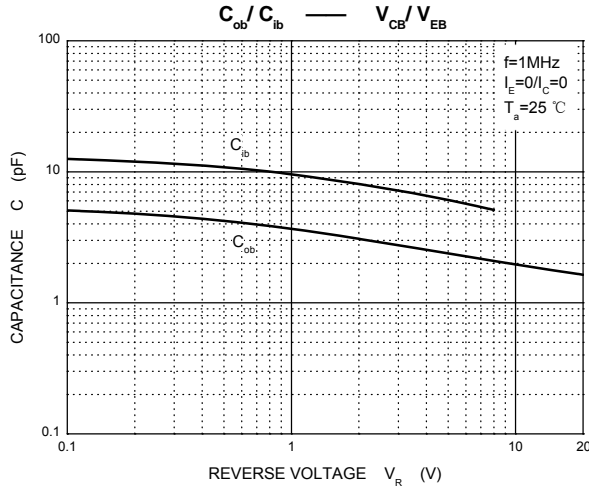

SOT-23 Package Outline Dimensions

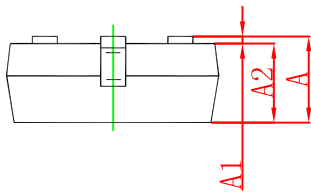
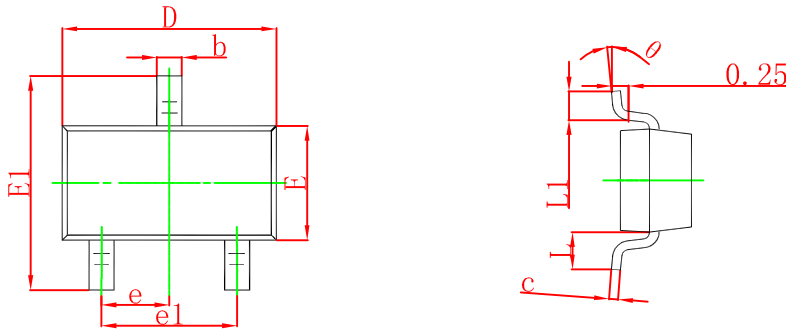

Symbol	Dimensions In Millimeters		Dimensions In Inches	
	Min	Max	Min	Max
A	0.900	1.150	0.035	0.045
A1	0.000	0.100	0.000	0.004
A2	0.900	1.050	0.035	0.041
b	0.300	0.500	0.012	0.020
c	0.080	0.150	0.003	0.006
D	2.800	3.000	0.110	0.118
E	1.200	1.400	0.047	0.055
E1	2.250	2.550	0.089	0.100
e	0.950 TYP		0.037 TYP	
e1	1.800	2.000	0.071	0.079
L	0.550 REF		0.022 REF	
L1	0.300	0.500	0.012	0.020
θ	0 $^\circ$	8 $^\circ$	0 $^\circ$	8 $^\circ$

SOT-23 Plastic-Encapsulate Transistors

SOT-23 Suggested Pad Layout

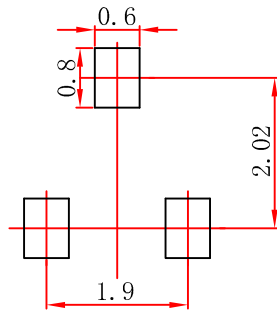

Note:

1. Controlling dimension: in millimeters.
2. General tolerance: $\pm 0.05\text{mm}$.
3. The pad layout is for reference purposes only.

NOTICE

Fangjing reserve the right to make modifications, enhancements, improvements, corrections or other changes without further notice to any product herein. Fangjing does not assume any liability arising out of the application or use of any product described herein.

SOT-23 Tape and Reel

SOT-23 Embossed Carrier Tape

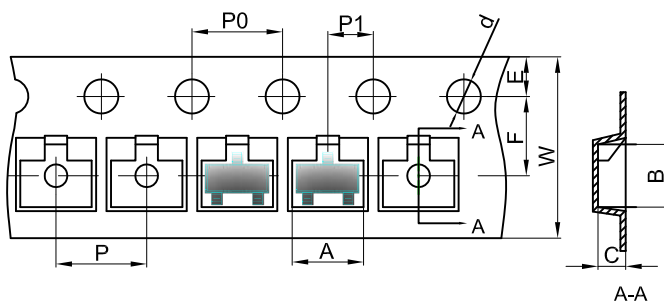

Packaging Description:

SOT-23 parts are shipped in tape. The carrier tape is made from a dissipative (carbon filled) polycarbonate resin. The cover tape is a multilayer film (Heat Activated Adhesive in nature) primarily composed of polyester film, adhesive layer, sealant, and anti-static sprayed agent. These reeled parts in standard option are shipped with 3,000 units per 7" or 17.8cm diameter reel. The reels are clear in color and is made of polystyrene plastic (anti-static coated).

Dimensions are in millimeter

Pkg type	A	B	C	d	E	F	P0	P	P1	W
SOT-23	3.15	2.77	1.22	$\varnothing 1.50$	1.75	3.50	4.00	4.00	2.00	8.00

SOT-23 Plastic-Encapsulate Transistors

SOT-23 Tape Leader and Trailer

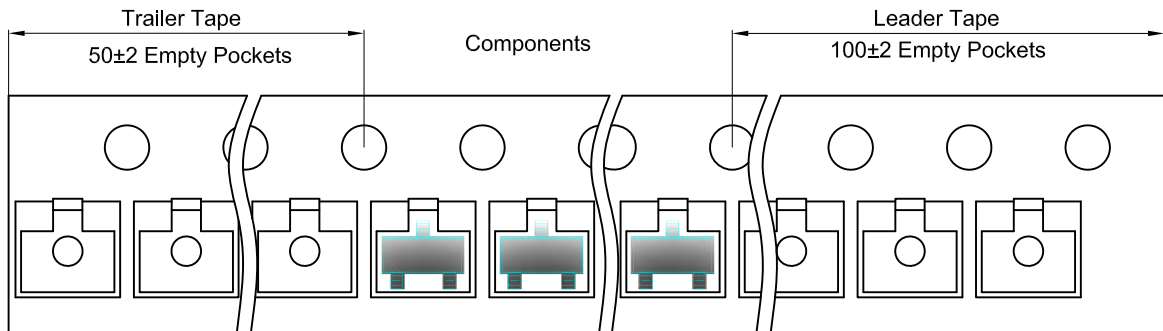

SOT-23 Reel

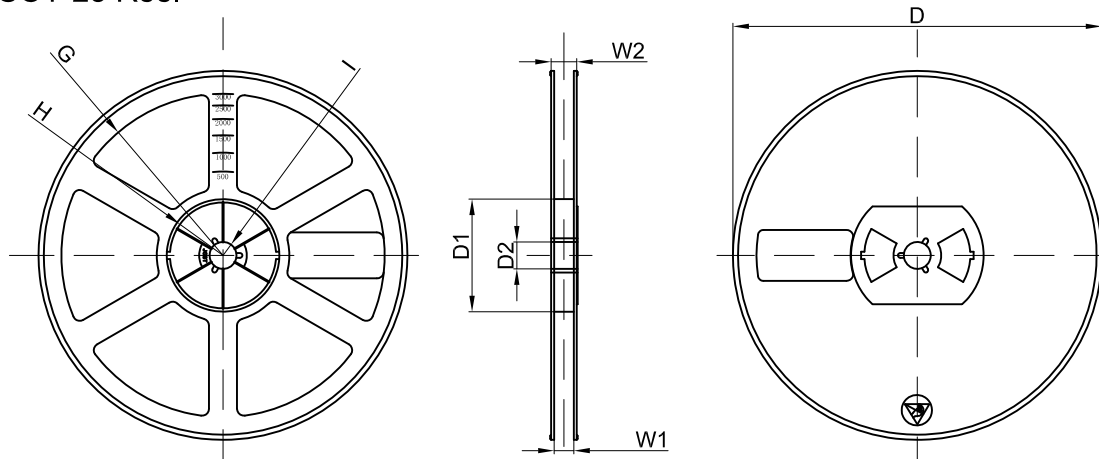

Dimensions are in millimeter								
Reel Option	D	D1	D2	G	H	I	W1	W2
7" Dia	Ø178.00	54.40	13.00	R78.00	R25.60	R6.50	9.50	12.30

REEL	Reel Size	Box	Box Size(mm)	Carton	Carton Size(mm)	G.W.(kg)
3000 pcs	7 inch	45,000 pcs	203×203×195	180,000 pcs	438×438×220	